

Installation Guide

8-Port 10/100Mbps Desktop Switch with 4-Port PoE

TL-SF1008P

PoE MAX



On: $50W \leq \text{Total power supply} < 57W$
 Flashing: Total power supply = 57W
 Off: Total power supply < 50W

Power



On: Power on
 Off: Power off

PoE Status (port 1-4)



On: PoE power provided
 Flashing: PoE fault
 Off: No PoE power provided

Link/Act (port 1-8)



On: Link present but no activity
 Flashing: Transmitting/receiving data
 Off: No link

Connection

1. Application

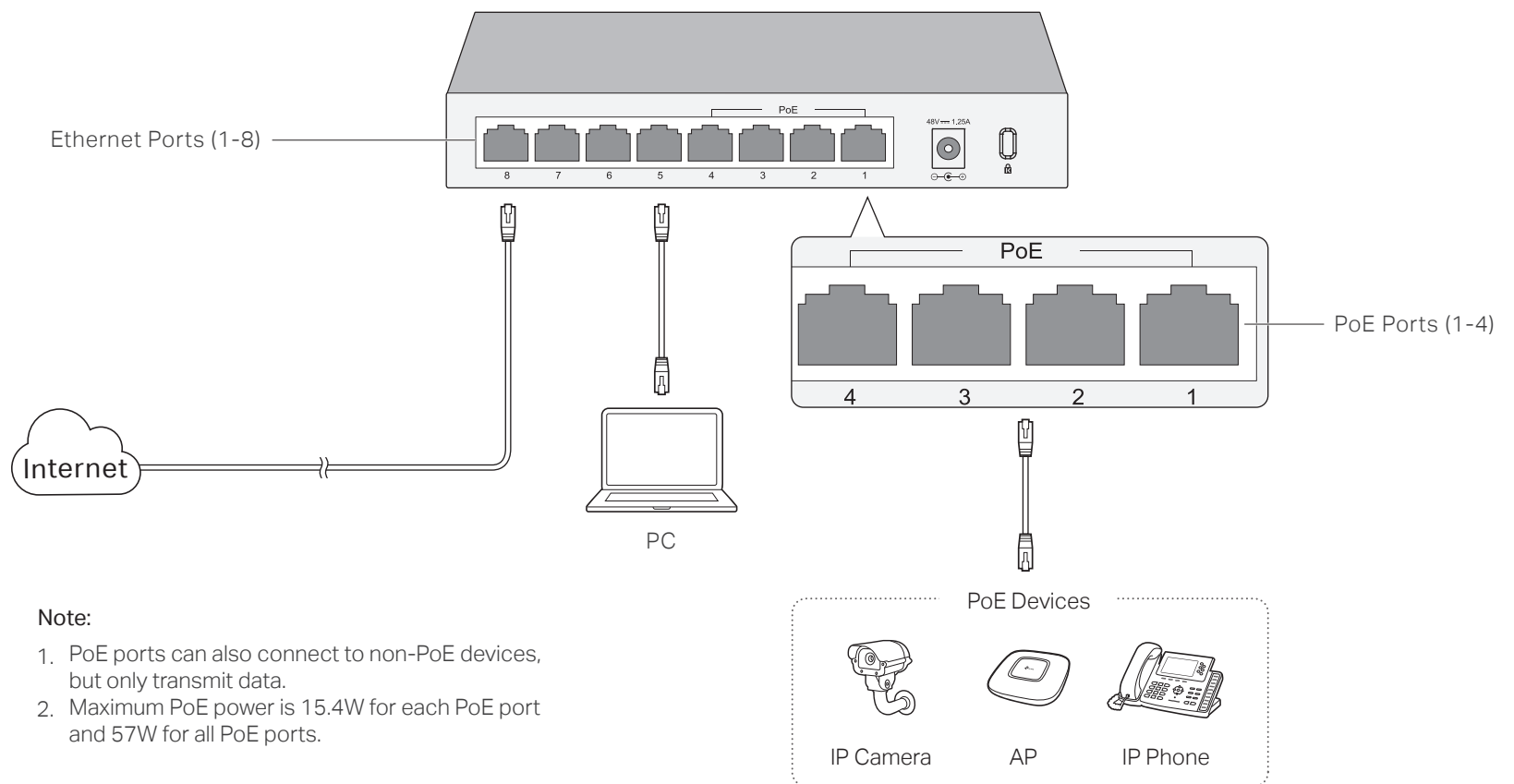

2. Plug and Play

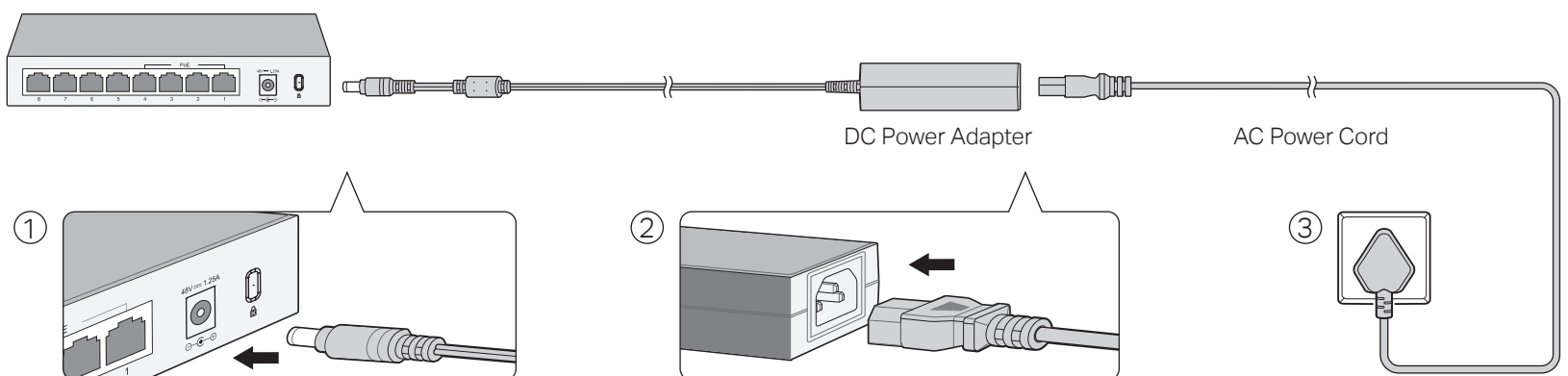

Frequently Asked Questions (FAQ)

Q1. The Power LED is not lit.

The Power LED should be lit when the power system is working normally. If the Power LED is not lit, please check as follows:

A1: Make sure the AC power cord is connected the switch with power source properly.

A2: Make sure the voltage of the power supply meets the requirements of the input voltage of the switch.

A3: Make sure the power source is on.

Q2. The Link/Act LED is not lit when a device is connected to the corresponding port.

It is recommended that you check the following items:

A1: Make sure that the cable connectors are firmly plugged into the switch and the device.

A2: Make sure the connected device is turned on and working well.

A3: The cable must be less than 100 meters long (328 feet).

Q3. Why is port 4 not supplying power for PoE devices?

If connected PoE device's total power consumption exceeds 57W, the system will cut off the power to port 4. For example, port 1, 2 and 4 are consuming 15.4W respectively, if an additional PoE device with 12W is inserted to port 3, the system will cut off the power of port 4 to compensate for the overload.

 For technical support and other information, please visit <http://www.tp-link.com/support>

Specifications

General Specifications

Standard	IEEE802.3i, 802.3u, 802.3x, 802.3af
Protocol	CSMA/CD
Interface	8 10/100Mbps RJ45 Ports Auto-Negotiation/Auto MDI/MDIX
Network Media (Cable)	10BASE-T: UTP category 3, 4, 5 cable (maximum 100m) EIA/TIA-568 100Ω STP (maximum 100m) 100BASE-TX: UTP category 5, 5e cable (maximum 100m) EIA/TIA-568 100Ω STP (maximum 100m)
PoE Ports (RJ45)	PoE Ports: Port1- Port4 Total Power Supply: 57W
Backbone Bandwidth	1.6Gbps
MAC Address Table	2K
Transfer Method	Store-and-Forward
Power Supply	External Power Adapter (Input 100-240VAC, 50/60Hz Output: 48VDC /1.25A)
Consumption	2.3 watts (max. no PoE device connected) 59.3 watts (max. with 57w PoE device connected)
Fan Quantity	Fanless

Environmental and Physical Specifications

Certification	FCC, CE, RoHS
Operating Temperature	0 °C to 40 °C (32 °F to 104 °F)
Storage Temperature	-40 °C to 70 °C (-40 °F to 158 °F)
Operating Humidity	10% to 90% non-condensing
Storage Humidity	5% to 90% non-condensing

FCC STATEMENT

This equipment has been tested and found to comply with the limits for a Class A digital device, pursuant to part 15 of the FCC Rules. These limits are designed to provide reasonable protection against harmful interference when the equipment is operated in a commercial environment. This equipment generates, uses, and can radiate radio frequency energy and, if not installed and used in accordance with the instruction manual, may cause harmful interference to radio communications. Operation of this equipment in a residential area is likely to cause harmful interference in which case the user will be required to correct the interference at his own expense.

This device complies with part 15 of the FCC Rules. Operation is subject to the following two conditions:

- 1) This device may not cause harmful interference.
- 2) This device must accept any interference received, including interference that may cause undesired operation.

Any changes or modifications not expressly approved by the party responsible for compliance could void the user's authority to operate the equipment.

 この装置は、クラスA情報技術装置です。この装置を家庭環境で使用すると電波妨害を引き起こすことがあります。この場合には使用者が適切な対策を講ずるよう要求されることがあります。 VCCI-A

SAFETY NOTICES

⚠ Cautions

Do not use this product near water, for example, in a wet basement or near a swimming pool.
Avoid using this product during an electrical storm. There may be a remote risk of electric shock from lightning.



CE Mark Warning

This is a class A product. In a domestic environment, this product may cause radio interference, in which case the user may be required to take adequate measures.



Продукт сертифіковано згідно з правилами системи УкрСЕПРО на відповідність вимогам нормативних документів та вимогам, що передбачені чинними законодавчими актами України.

Explanation of the symbols on the product label

	DC voltage
	RECYCLING This product bears the selective sorting symbol for Waste electrical and electronic equipment (WEEE). This means that this product must be handled pursuant to European directive 2012/19/EU in order to be recycled or dismantled to minimize its impact on the environment. User has the choice to give his product to a competent recycling organization or to the retailer when he buys a new electrical or electronic equipment
	Indoor use only